

SECTIONAL DETAIL RAIN WATER SOAK PIT
SCALE: N.T.S.

SECTION :- C-C-D
SCALE: 1:100

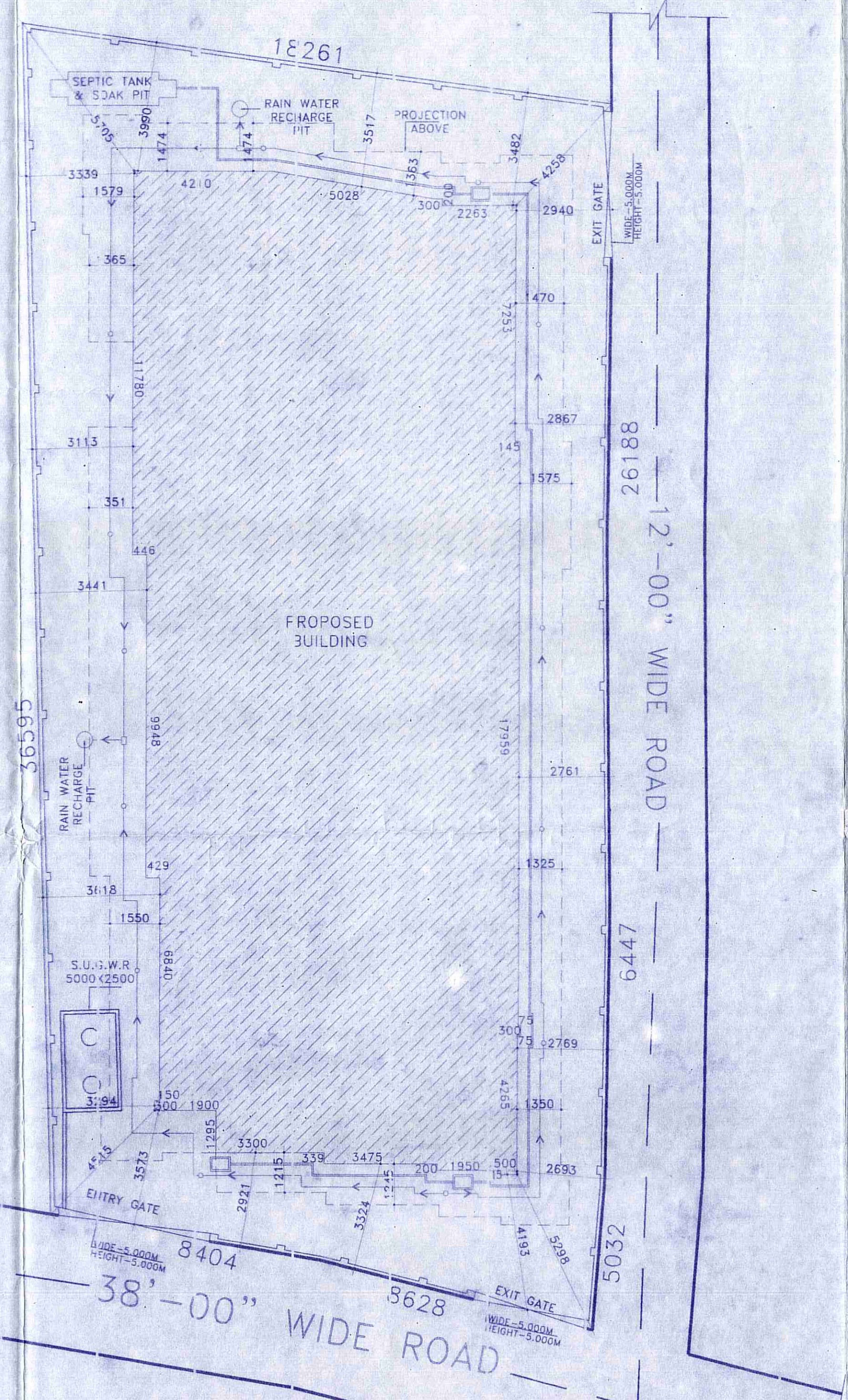

SITE PLAN
SCALE: 1:100

SCHEDULE OF DOOR & WINDOW:-

MARK	SIZE	DESCRIPTION
D1	1000X100	FULLY PNL
D2	900X100	FULLY PNL
D3	750X100	FULLY PNL
W	1800X 200	SLIDING WINDOW
W2	1000X 200	SLIDING WINDOW
W3	1250X 200	SLIDING WINDOW
V	600X450	JPMC MOVABLE VENTILATOR
V1		VENTILATION FOR STAIR CASE

PROJECT NAME:-
 PLAN OF PROPOSED (G+8) NINE STORED RESIDENTIAL CUM COMMERCIAL APARTMENT BUILDING OF MR. SURAJIT BANIK S/O MR. SUBHASH CHANDRA BANIK, SMT. SAMARPITA SAHA BANIK W/O LITAN SAHA, R.S. PLOT NO.-43/67, L.R. PLOT NO.- 191,192, J.L. NO.-R.S-96, L.R-111, KHATIAN NO.-R.S-67,148,328, L.R-1E72,1980, M.C.U.ZA-TETIKHOLA, P.S-NIPS, DIST- PASCHIM BARDHAMAN, WEST BENGAL.

- NOTES :-
1. ALL DIMENSIONS ARE IN M.M. AND ALL LEVEL ARE IN M.
 2. WRITTEN DIMENSIONS MUST BE FOLLOWED.
 3. ALL EXTERNAL WALLS 250TH. & INTERNAL WALLS 125THK. UNLESS OTHERWISE MENTIONED.
 4. ALL MASONRY WORKS ARE BOUNDED BY CEMENT MORTAR (1:6) & (1:4).
 5. EXTERNAL PLASTER IS 25THK. & INTERNAL PLASTER IS 12MM THK.
 6. ALL CONC. GRADE IS M25 & AND GRADE OF STEEL FE-500
 7. 250THK. BRICK WORK IN 1:6 MORTAR
 8. 125THK. & 75THK. BRICK WORK IN 1:4 MORTAR
 9. 150 VIDE SURFACE DRAIN SHOULD BE PROVIDED ALL ROUND THE BUILDING.
 10. 25% OF THE BUILDING TO BE CONSTRUCTED USING FLY-ASH BRICKS

AREA CALCULATION:-

LAND AREA	PLINTH AREA	
	FLOOR	AREA
647.88 SQ.M.	GROIND FLOOR	340.87 SQ.M.
	FIRST FLOOR	457.00 SQ.M.
	SECOND FLOOR	457.00 SQ.M.
	THIRD FLOOR	457.00 SQ.M.
	FOURTH FLOOR	457.00 SQ.M.
	FIFTH FLOOR	457.00 SQ.M.
	SIXTH FLOOR	457.00 SQ.M.
	SEVENTH FLOOR	457.00 SQ.M.
TOTAL		3996.87 SQ.M.

GROUND COVERAGE = 52.61 %
 F.A.R. = 2.25

SIGNATURE OF STRUCTURAL ENGINEER:-

Harsh Prakash
 Harsh Prakash
 Structural Engineer
 Lic. No. - 16/PMT/162/AMC/DMC/PPD/165
 DCE, B.TECH., G.I.D.S., Durgapur-16
 Contact No. 9333253331

OFFICE USED:-

Approved Plan No. 39 on Meeting No. 02/20-21, Date 13/07/2020 Valid upto 22/02/2023
Malika Lata
 Pradhan
 Jinnia Gram Panchayat

TITLE:-
 SECTIONAL VIEW, SITE PLAN, SECTIONAL DETAILS OF RAIN WATER SOAK PIT.

CERTIFICATE & SIGNATURE OF ARCHITECT:-
 CERTIFICATE OF GEO-TECHNICAL ENGINEER:-
 SIGNATURE OF DEVELOPER/OWNER

Cashani
 VAISHNAVI MAKARAND ATHALYE
 CONSULTING ARCHITECT
 GA/2018/101108

RAJIB MAITY
 Civil & Geotechnical Engineer
 CE, M.I.S.E. - 14115161
 Lic. No. - LBR/1162/AMC
 G.I.D.S., Durgapur - 16

Surajit Banik
 Samarpita Saha Banik



GIDS Engineering Pvt. Ltd.
 (Architects, Engineers, Contractors and Business Solutions)
 E-mail Id:- gidsbengal@gmail.com & gidsbengal.project@gmail.com
 SPECIALIST IN CONSULTING, STRUCTURAL DESIGN, SURVEYING & SOIL INVESTIGATING
 OFFICE:- C-29, Doctor's Colony, 4th street, City Centre, Durgapur - 713216
 Contact No:- +919333333331, +917699991140

CHECKED BY : P.DAS
 DRAWN BY : A.KUMAR
 DATE : 29.02.2020 REV-00
 SCALE : 1:100, N.T.S.
 PROJECT:- ICHCHEMGE APARTMENT
 SHEET NO:- GIDS/ARCH03-03